

## PRODUCT WARNING

1. Do not lean diffuser during operation.
2. Unplug from mains power when filling or cleaning.
3. Do not empty water from the side which the air vent is located.
4. This appliance is not intended for use by children.
5. If the diffuser is accidentally knocked over during operation, water may enter the internal space. If so, please unplug the diffuser, empty any remaining water and allow to dry for 3 days. If any issues arise please contact your local retailer.

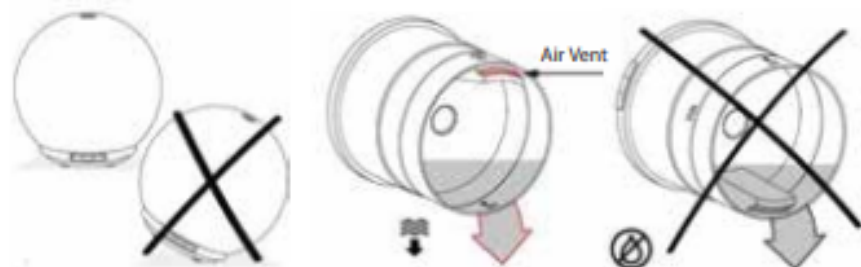

ALCYON

[www.alcyon.com.au](http://www.alcyon.com.au)

ALCYON

## GALAXY Ultrasonic 3D Glass Aroma Diffuser



[www.alcyon.com.au](http://www.alcyon.com.au)

## TABLE OF CONTENTS:

- A** Function
- B** Specifications
- C** Diffuser Setup
- D** Maintenance
- E** Troubleshooting
- F** Warranty



## FUNCTION

With an innovative and unique design, the GALAXY Ultrasonic Aroma Diffuser combines the DNA of both oriental and western cultures to bring you this fashionable diffuser.

Utilising the instantaneous benefits of ultrasonic vibrations, GALAXY works silently in the background to break down your fragrance infused water into a microscopic mist that easily dissipates into the atmosphere. Leaving your mind, body and soul at peace.



## SPECIFICATIONS

Product Name: GALAXY Aroma Diffuser  
Voltage: DC 24V  
Power: 12 w  
Water Capacity: 200 ml  
Mist Output: 15/22/30 ml/h  
Duration: 12/9/6 hrs [approx.]  
LED Effect: Colour Morphing  
+ Selectable



Diffuser Operation					
Mist Button		On/Off Button		Night-light Effect	
First	Medium Output	First	On	First	Colour Changing
Second	Low Output	Second	Off	Second	Fixed Colour
Third	High Output			Third	Light Off
					Off

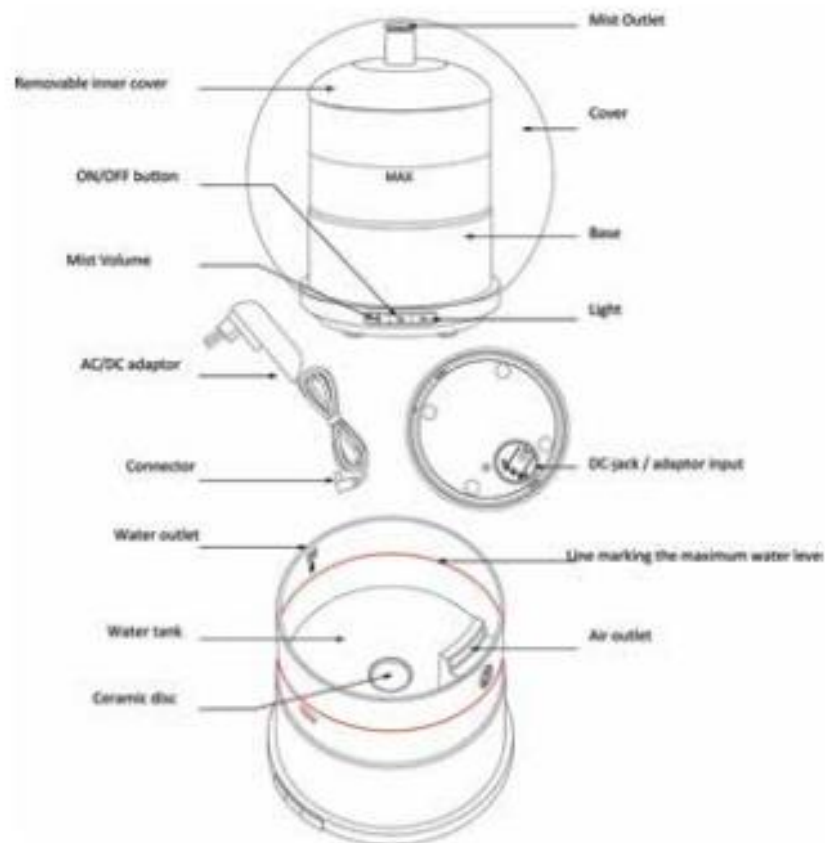



## DIFFUSER SETUP

1. Place diffuser on a flat and even surface, clear of any loose or foreign objects.
2. Fill water tank to max level line - 200ml.
3. Add up to 3-6 drops of essential or fragranced oils.
4. Replace cover & connect power.
5. Press On/Off Button to turn diffuser on.
5. Press the Mist Button for desired mist output.
6. Press the Light Button for desired light effect.



Connect Power Cord

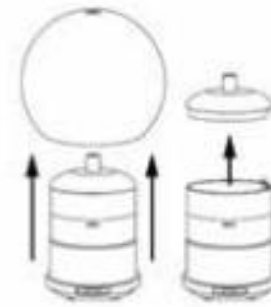

Lift & remove covers from base



Fill with water up to max level line



Add 3-6 drops of your favourite oil

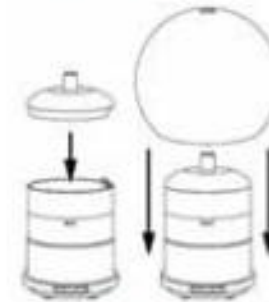

Replace outer and inner cover

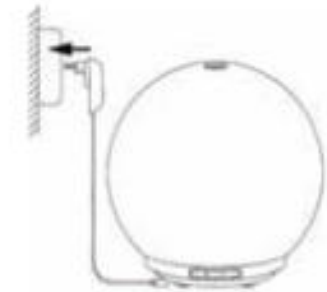

Plug in power adaptor into outlet

# D

## MAINTENANCE

To keep your diffuser in great working order, we recommend that you clean once a week.

1. Turn off diffuser and unplug from power.
2. Remove cover.
3. Empty any remaining water from tank.
4. Wash with a 50/50 mix of vinegar and warm water.
5. Clean water tank and around ultrasonic pad with a clean, soft-cotton tip.
6. Replace cover and clean exterior with clean damp cloth.

We recommend that if not in use for a prolonged period, please remove any standing water

For further Diffuser Maintenance, please visit: [www.alcyon.com.au](http://www.alcyon.com.au)



Unplug diffuser from mains power

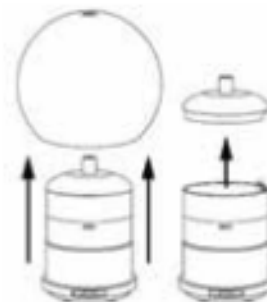

Lift & remove cover



Empty any remaining water

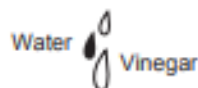

Wash with the water/vinegar mix



Lightly wipe internals with clean cloth

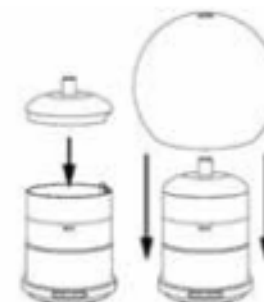

Replace cover and wipe exterior



## TROUBLESHOOTING

Symptom	Possible Cause	Solution
<b>NO MIST</b>	Power not connected	Plug in power adaptor and press mist button to activate
	Insufficient water	Fill tank with water
	Too much water (50ml+)	Tip out excess water
	The mist outlet blocked by water droplets or oil build-up	Clean outlet vent cotton tip
	Poor performance due to dirty	Clean ultrasonic pad
	Cover not seated or sealed properly against base unit	Reseat cover



## WARRANTY CARD

All Alcyon Ultrasonic Diffusers are covered by a limited one year warranty from date of purchase.

Date of purchase: \_\_\_\_ / \_\_\_\_ / \_\_\_\_  
(please keep your receipt with Warranty Card as Proof of Purchase)

Should you be experiencing any issues with your diffusers, please visit [www.alcyon.com.au](http://www.alcyon.com.au) or call 1300 882 332.  
(please have your diffuser on hand when calling)

### Terms and Conditions:

- A dated receipt is required as Proof of Purchase for warranty purposes.
- This warranty is for operational faults only, and does not cover issues such as breakages or faults arising from misuse.
- Any returned items from customers to Alcyon will be at the consumer's expense and must be accompanied with a RA (Return Authorisation) number issued by Alcyon. Unless a prior arrangement has been made.
- Any goods received without a RA number will not be accepted and returned to the sender.
- The determination of faults is at the discretion of Alcyon Australia, with the item to be either repaired or replaced.
- Return shipping from Alcyon to the customer is to be at Alcyon's expense.

Alcyon Australia  
PO Box 50  
LINFIELD NSW 2070

1300 882 332

[info@alcyon.com.au](mailto:info@alcyon.com.au)  
[www.alcyon.com.au](http://www.alcyon.com.au)